

Delete password (as of FW 1.163)

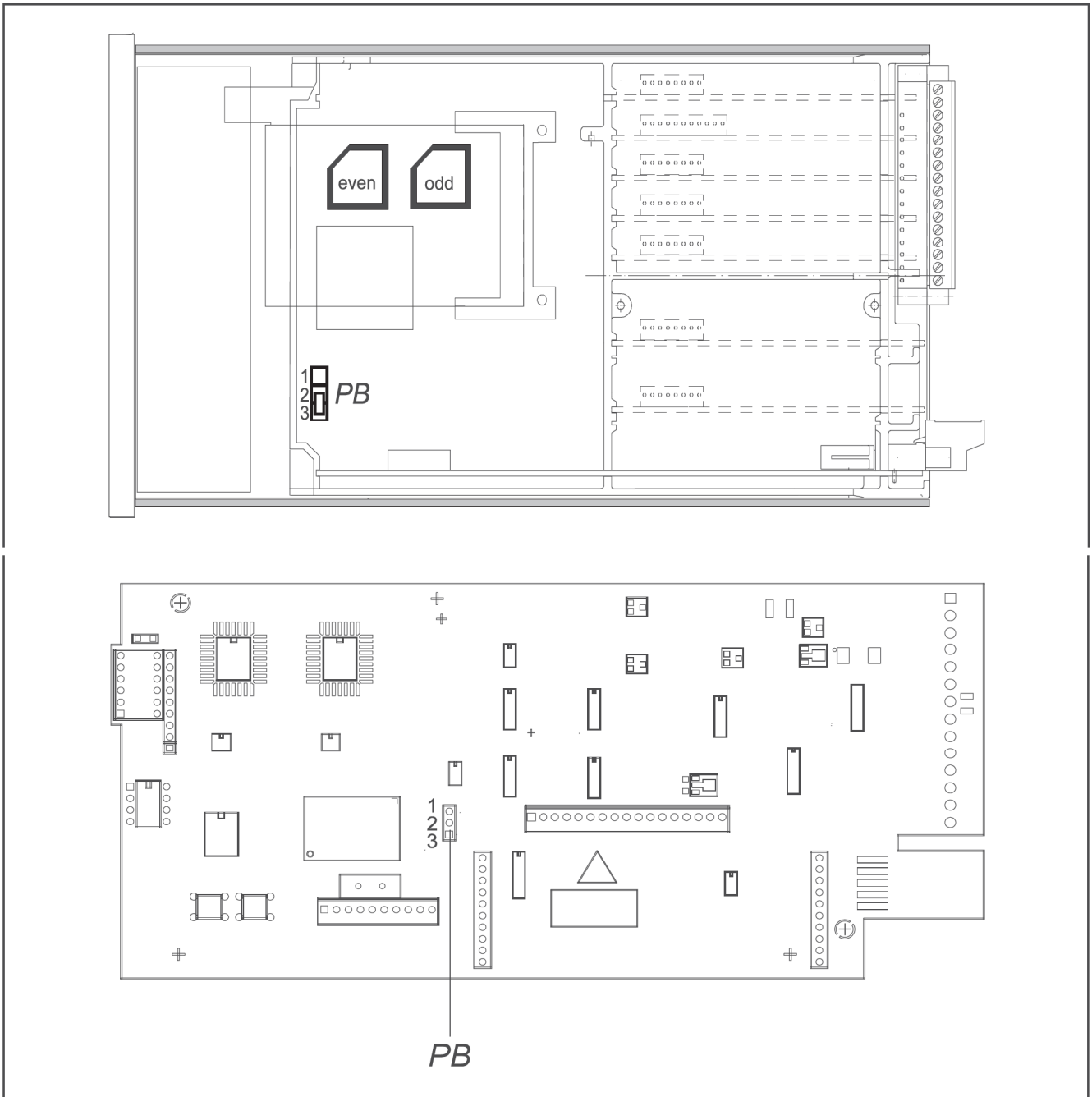

Fig. 92 above Motherboard Protronic 100 / 500
 Z-19090 below Motherboard Digitric 500
 Z-19091 PB Password bridge

1. Switch off power supply.
2. Dismantle unit and open.
 (Protronic 100/ 500: Operation Manual 42/62-50011).
 (Digitric 500: Operation Manual 42/61-50011).

If the plug-in jumpers *PB* connect posts 1 and 2, the adjusted password will be active. If the plug-in jumper is changed to posts 2 and 3, the adjusted password will no longer be required.

3. Change the plugging of bridge *PB*.
4. Close unit and install.
5. Connect power supply.

The levels protected with password are freely accessible.

6. Read password and eventually modify.
7. Replug the plug-in jumper according to steps 1-5.